

**Technical Data Sheet**  
**TDS-07-95****CreaZen® Swing Gate****1 Scope**

This technical data sheet specifies requirements for swing gates with CreaZen® infill panel. The gate consists of different components:

- Gate posts (hinge post and latch post)
- Wing
- Accessories (hinges, lock-system, ground bolt)

There are 2 types: Single CreaZen® swing gates (figure 1) and double CreaZen® swing gates (figure 2). CreaZen® swing gates are CE labelled, in accordance with EN 13241-1.

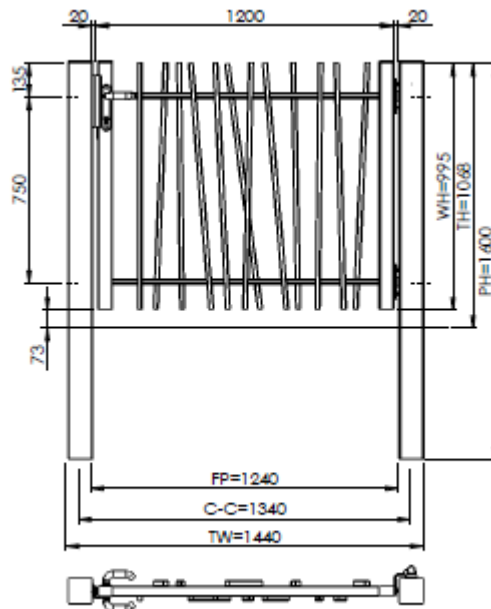

**Figure 1: Single CreaZen® swing gate**

Page: 1 / 15  
Date: 09-12-2016  
Replaces version:  
15-04-2016

Made up by:  
Werner Frans  
Group Quality  
Department

Approved by:  
Bart Catteeuw  
Product Manager

Approved by:  
Rafal Jordan  
Plant Manager

Approved by:  
Willy Naesens  
Group Quality  
Manager

*The information and data given are typical for the product described. However technical changes are possible without any notice.*

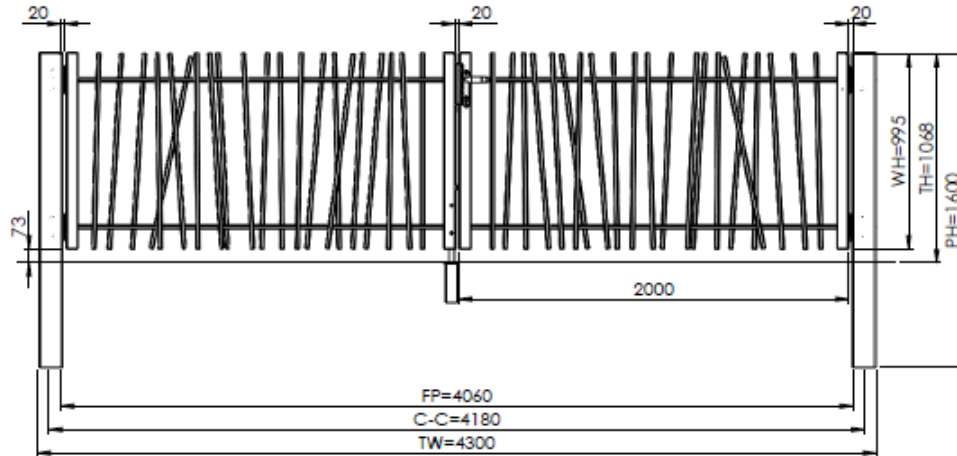
**Technical Data Sheet**  
**TDS-07-95****CreaZen® Swing Gate****Figure 2: Double CreaZen® swing gate****1.1 Normative References**

- EN 13241-1: Industrial, commercial and garage doors and gates - Product standard - Part 1: Products without fire resistance or smoke control characteristics.
- EN 10219-1: Cold formed welded structural hollow sections of non-alloy and fine grain steels – Part 1: technical delivery conditions.
- EN 10025-2: Hot rolled products of structural steels – Part2: Technical delivery conditions for non-alloy structural steels.
- ISO 1461: Hot dip galvanized coatings on fabricated iron and steel articles - Specifications and test methods.
- EN 10088-3: Technical delivery conditions for semi-finished products, bars, rods, wire, sections and bright products of corrosion resisting steels for general purposes.
- ISO 2768-1: General tolerances - Part 1: Tolerances for linear and angular dimensions without individual indications.
- ISO 9227: Corrosion tests in artificial atmospheres; salt spray tests.
- ISO 16474-3: Paints and varnishes – Methods of exposure to laboratory light sources – Part 3: Fluorescent UV lamps.

Page: 2 / 15  
Date: 09-12-2016  
Replaces version:  
15-04-2016Made up by:  
Werner Frans  
Group Quality  
DepartmentApproved by:  
Bart Catteeuw  
Product ManagerApproved by:  
Rafal Jordan  
Plant ManagerApproved by:  
Willy Naesens  
Group Quality  
Manager

*The information and data given are typical for the product described. However technical changes are possible without any notice.*

Technical Data Sheet  
TDS-07-95

## CreaZen® Swing Gate

### 2 Raw materials

#### 2.1 Steel used for the square gate posts

The gate posts are made out of construction steel: Type S235 JRH class 1, in accordance with EN 10219-1.

Yield strength: Min. 235 N/mm<sup>2</sup>

#### 2.2 Steel used for the CreaZen® panels

The CreaZen® panels are made out of construction steel: Type S235 in accordance with EN 10025-2.

Yield strength: Min. 235 N/mm<sup>2</sup>

#### 2.3 Stainless steel for the hinges and the lock system

The hinges and parts of the lock system are made out of stainless steel, grade 304, number 1.4301 in accordance with EN 10088-3.

#### 2.4 Zinc (Zinc used for hot dip galvanisation bath)

In accordance with ISO 1461.

#### 2.5 Polyester

The polyester is free from Lead and Cadmium.

Page: 3 / 15 Date: 09-12-2016 Replaces version: 15-04-2016	Made up by: Werner Frans Group Quality Department	Approved by: Bart Catteeuw Product Manager	Approved by: Rafal Jordan Plant Manager	Approved by: Willy Naesens Group Quality Manager
---	--	--	---	---

The information and data given are typical for the product described. However technical changes are possible without any notice.

Technical Data Sheet  
TDS-07-95

## CreaZen® Swing Gate

### 3 Properties

#### 3.1 General properties of the single and double CreaZen® swing gates

See tables 1 and 2.

**Table 1: General dimensions of the single CreaZen® Swing gates**

SINGLE SWING GATES							
Width (mm)	Height (mm)	Gate post (mm)	Wing height (mm)	Total height (mm)	Opening (mm)	Centre- centre (C-C) (mm)	CreaZen® panel (Width x height) (mm)
1200	1000	100 x 100 x 3 x 1600	995	1068	1240	1340	1200 x 995
	1200	100 x 100 x 3 x 1800	1195	1268	1240	1340	1200 x 1195
	1500	100 x 100 x 3 x 2100	1495	1568	1240	1340	1200 x 1495
	1700	100 x 100 x 3 x 2300	1695	1768	1240	1340	1200 x 1695
	2000	100 x 100 x 3 x 2600	1995	2068	1240	1340	1200 x 1995

**Table 2: General dimensions of the double CreaZen® Swing gates**

DOUBLE SWING GATES							
Width (mm)	Height (mm)	Gate post (mm)	Wing height (mm)	Total height (mm)	Opening (mm)	Centre- centre (C-C) (mm)	2x CreaZen® panels (Width x height) (mm)
4000	1000	120 x 120 x 3 x 1600	995	1068	4060	4180	2000 x 995
	1200	120 x 120 x 3 x 1800	1195	1268	4060	4180	2000 x 1195
	1500	120 x 120 x 3 x 2100	1495	1568	4060	4180	2000 x 1495
	1700	120 x 120 x 3 x 2300	1695	1768	4060	4180	2000 x 1695
	2000	120 x 120 x 3 x 2600	1995	2068	4060	4180	2000 x 1995

All other dimensions are specified in the corresponding technical drawings, available on request.

Each gate can be used in 4 different opening directions:

- Left outside
- Left inside
- Right outside
- Right inside

Page: 4 / 15 Date: 09-12-2016 Replaces version: 15-04-2016	Made up by: Werner Frans Group Quality Department	Approved by: Bart Catteeuw Product Manager	Approved by: Rafal Jordan Plant Manager	Approved by: Willy Naesens Group Quality Manager
---	--	--	---	---

The information and data given are typical for the product described. However technical changes are possible without any notice.

Technical Data Sheet  
TDS-07-95

## CreaZen® Swing Gate

### 3.2 CreaZen® panel

The CreaZen® panel is made out of bended steel tubes (See § 2.2), welded together, and subsequently hot dip galvanized and polyester coated.

#### 3.2.1 Dimensions and tolerances

##### Vertical Square Tubes:

Section of the vertical square tubes: 20 x 20 mm.

Material thickness of the vertical square tubes: 1,5 mm ± 0,15 mm

##### Horizontal profile:

The dimensions of the section of the horizontal profile are given in figure 3.

Section of the vertical square tubes: 40 x 20 mm.

Material thickness: 2,00 mm.

Tolerance on material thickness: ± 0,20 mm.

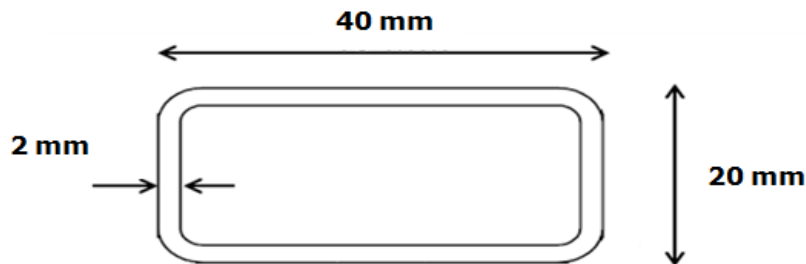

**Figure 3: Section of the horizontal profile**

Other dimensions and tolerances: See corresponding technical drawings.

Page: 5 / 15 Date: 09-12-2016 Replaces version: 15-04-2016	Made up by: Werner Frans Group Quality Department	Approved by: Bart Catteeuw Product Manager	Approved by: Rafal Jordan Plant Manager	Approved by: Willy Naesens Group Quality Manager
---	--	--	---	---

The information and data given are typical for the product described. However technical changes are possible without any notice.

Technical Data Sheet  
TDS-07-95

## CreaZen® Swing Gate

Overview of standard infill panels: See table 3 and 4

<b>Table 3 : Dimensions CreaZen® infill panels for single swing gates</b>	
Panel Width (mm)	Panel Height (mm)
1200	995
1200	1195
1200	1495
1200	1695
1200	1995

<b>Table 4 : Dimensions CreaZen® infill panels for double swing gates</b>	
Panel Width (mm)	Panel Height (mm)
2000	995
2000	1195
2000	1495
2000	1695
2000	1995

### 3.2.2 Welding

The vertical tubes are MIG welded at the underside of the horizontal profiles which makes the weld seams almost invisible.

See picture 1.

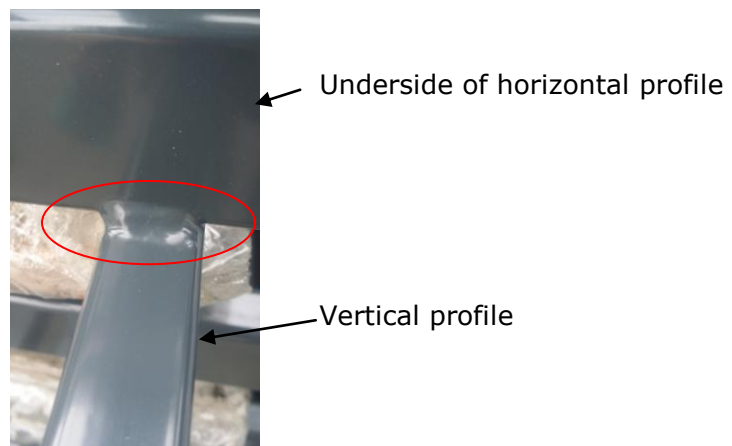

**Picture 1**

Page: 6 / 15 Date: 09-12-2016 Replaces version: 15-04-2016	Made up by: Werner Frans Group Quality Department	Approved by: Bart Catteeuw Product Manager	Approved by: Rafal Jordan Plant Manager	Approved by: Willy Naesens Group Quality Manager
---	--	--	---	---

The information and data given are typical for the product described. However technical changes are possible without any notice.

## CreaZen® Swing Gate

### 3.3 Square gate posts

The square gate posts are made out of steel (See § 2.1), hot dip galvanized and subsequently polyester coated.

#### 3.3.1 Dimensions and tolerances

Dimensions of the square gate posts, see table 5

<b>Table 5: Dimensions of the square gate posts</b>		
Single swing gate		
Width of the gate (mm)	Height of the gate (mm)	Post dimensions (mm)
1200	1000	100 x 100 x 3 x 1600
	1200	100 x 100 x 3 x 1800
	1500	100 x 100 x 3 x 2100
	1700	100 x 100 x 3 x 2300
	2000	100 x 100 x 3 x 2600
Double swing gate		
Width of the gate (mm)	Height of the gate (mm)	Post dimensions (mm)
4000	1000	120 x 120 x 3 x 1600
	1200	120 x 120 x 3 x 1800
	1500	120 x 120 x 3 x 2100
	1700	120 x 120 x 3 x 2300
	2000	120 x 120 x 3 x 2600

Tolerance on the side lengths (section):

Side length 100 x 100: ± 0,30 mm in accordance with ISO 2768-1

Side length 120 x 120: ± 0,50 mm in accordance with ISO 2768-1

Tolerance on the gate post plate thickness: ± 0,3 mm in accordance with ISO 2768-1 class c (coarse)

Page: 7 / 15 Date: 09-12-2016 Replaces version: 15-04-2016	Made up by: Werner Frans Group Quality Department	Approved by: Bart Catteeuw Product Manager	Approved by: Rafal Jordan Plant Manager	Approved by: Willy Naesens Group Quality Manager
---	--	--	---	---

*The information and data given are typical for the product described. However technical changes are possible without any notice.*

**Technical Data Sheet**  
**TDS-07-95****CreaZen® Swing Gate**

Tolerance on the post length:

For post heights > 1000 and ≤ 2000: ± 3 mm in accordance with ISO 2768-1 class c (coarse)

For post heights > 2000 and ≤ 4000: ± 4 mm in accordance with ISO 2768-1 class c (coarse)

Other dimensions and tolerances, see technical drawing available on request.

The hinge posts have 2 inserts at both sides.

Latch post has 2 inserts only at one side.

The inserts are used for the fence connection.

Post plate thickness range: 1 – 3 mm

The inserts are galvanized.

The same system is used as for standard end and corner posts.

To have one post for all opening directions of the gate, inserts are foreseen at two opposite sides of the profile.

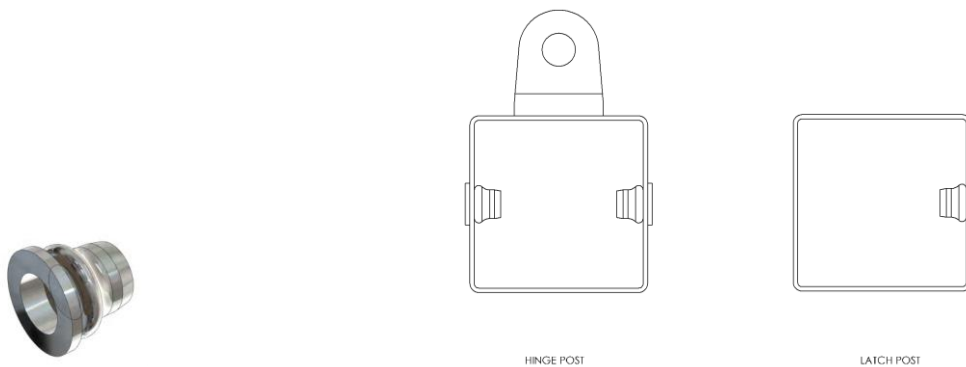

**Figure 4**

Page: 8 / 15 Date: 09-12-2016 Replaces version: 15-04-2016	Made up by: Werner Frans Group Quality Department	Approved by: Bart Catteeuw Product Manager	Approved by: Rafal Jordan Plant Manager	Approved by: Willy Naesens Group Quality Manager
---	--	--	---	---

*The information and data given are typical for the product described. However technical changes are possible without any notice.*



Technical Data Sheet  
TDS-07-95

## CreaZen<sup>®</sup> Swing Gate

### 4 Coating

#### 4.1 Metallic coating

The CreaZen<sup>®</sup> gate wing and gate posts are hot dip galvanized after welding, in accordance with ISO 1461.

Article and its thickness	Local coating thickness (minimum) <sup>a</sup>	Local coating mass (minimum) <sup>b</sup>	Mean coating thickness (minimum) <sup>c</sup>	Mean coating mass (minimum) <sup>b</sup>
	µm	g/m <sup>2</sup>	µm	g/m <sup>2</sup>
Steel > 6 mm	70	505	85	610
Steel > 3 mm to ≤ 6 mm	55	395	70	505
Steel ≥ 1,5 mm to ≤ 3 mm	45	325	55	395
Steel < 1,5 mm	35	250	45	325
Castings ≥ 6 mm	70	505	80	575
Castings < 6 mm	60	430	70	505

An excellent corrosion protection is obtained through the thick layer of zinc covering the entire surface, including the cut edges and the welds of the fabrication. Inherent to this process is the possible appearance of some visual surface roughness.

Page: 9 / 15 Date: 09-12-2016 Replaces version: 15-04-2016	Made up by: Werner Frans Group Quality Department	Approved by: Bart Catteeuw Product Manager	Approved by: Rafal Jordan Plant Manager	Approved by: Willy Naesens Group Quality Manager
---	--	--	---	---

*The information and data given are typical for the product described. However technical changes are possible without any notice.*

Technical Data Sheet  
TDS-07-95

## CreaZen® Swing Gate

### 4.2 Polyester coating

**Thickness polyester coating:**

The total layer is minimum 60 µm thick.

The polyester thickness is the average of 10 measurements done over 1 gate wing / post.

**Colour:** Anthracite RAL 7016.

Other standard colours are available and can be found in the technical data sheet TDS-99-03. (Polyester coating).

Non-standard colours: On request.

**Adhesion:**

Make two scratches by means of a hard metal pointed graving tool, penetrating through the metal and intersecting at an angle of  $30^\circ \pm 5^\circ$ . Lift a  $30^\circ$  peak with the point of a knife.

The coating shall not be able to be lifted from the metal by more than 5 mm.

**Resistance of the polyester to saltspray:**

Make a diagonal cross by means of a hard metal pointed graving tool, penetrating through the metal. Test in accordance with ISO 9227. After 1000 h there shall be no corrosion beneath the polyester or loss of adhesion in excess of 10 mm from the diagonals.

**Resistance against UV:** In accordance with ISO 16474-3.

After 1000 h QUV and after washing with pure water, the colour difference, expressed as  $\Delta E^*$  is maximum 3.

Loss of gloss: After 1000 hours max. 50 % of the original one, measured after being washed with pure water.

Page: 10 / 15 Date: 09-12-2016 Replaces version: 15-04-2016	Made up by: Werner Frans Group Quality Department	Approved by: Bart Catteeuw Product Manager	Approved by: Rafal Jordan Plant Manager	Approved by: Willy Naesens Group Quality Manager
--	--	--	---	---

*The information and data given are typical for the product described. However technical changes are possible without any notice.*

Technical Data Sheet  
TDS-07-95

## CreaZen® Swing Gate

### 5 Accessories

#### 5.1 Hinges

The hinge with quick-fix system is made out of stainless steel, grade 304, number 1.4301 in accordance with EN 10088-3.

The hinge axis is made out of stainless steel, grade 302.

On the hinge part with the quick-fix system, a cover made out polyoximethyleen is mounted.

The hinge is adjustable in three dimensions : Height, Left / right alignment and swing direction.

The hinges allow the gate leaves to open up to 180° in the opening direction.

See figure 5

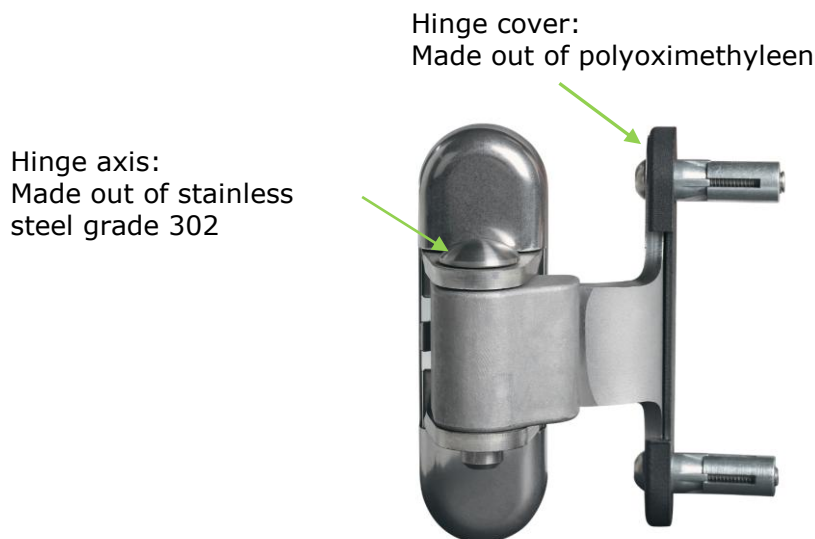

**Figure 5**

Page: 11 / 15 Date: 09-12-2016 Replaces version: 15-04-2016	Made up by: Werner Frans Group Quality Department	Approved by: Bart Catteeuw Product Manager	Approved by: Rafal Jordan Plant Manager	Approved by: Willy Naesens Group Quality Manager
--	--	--	---	---

*The information and data given are typical for the product described. However technical changes are possible without any notice.*

Technical Data Sheet  
TDS-07-95

## CreaZen® Swing Gate

### 5.2 Ground bolt VSF

Ground bolt:

Standard solution for double swing gates.

The holder for ground bolt is made out of hot dip galvanized steel and afterwards polyester coated in "silver".

The locking lever is made from Aluminium.



**Figure 6**

### 5.3 Slamplate

The lock catcher is made out of Inox. The slamplate is polyester coated in "silver".



**Figure 7**

Page: 12 / 15  
Date: 09-12-2016  
Replaces version:  
15-04-2016

Made up by:  
Werner Frans  
Group Quality  
Department

Approved by:  
Bart Catteeuw  
Product Manager

Approved by:  
Rafal Jordan  
Plant Manager

Approved by:  
Willy Naesens  
Group Quality  
Manager

*The information and data given are typical for the product described. However technical changes are possible without any notice.*

Technical Data Sheet  
TDS-07-95

## CreaZen® Swing Gate

### 5.4 Lock system

Lock System: Build-in lock system and coverplate are made out of stainless steel, grade 304, number 1.4301 in accordance with EN 10088-3.  
The handles are made out of aluminium.



**Figure 8**

### 5.5 Post cap

On each post there is black HDPE – standard, weatherproof and UV-resistant plastic cap mounted.



**Figure 9**

Page: 13 / 15 Date: 09-12-2016 Replaces version: 15-04-2016	Made up by: Werner Frans Group Quality Department	Approved by: Bart Catteeuw Product Manager	Approved by: Rafal Jordan Plant Manager	Approved by: Willy Naesens Group Quality Manager
--	--	--	---	---

*The information and data given are typical for the product described. However technical changes are possible without any notice.*

Technical Data Sheet  
TDS-07-95

## CreaZen® Swing Gate

### 6 Packaging

Each gate is wrapped with shrink foil and separately packed on a wooden pallet.  
See picture below.



**Picture 1**

Dimensions of the wooden pallets: 1600 x 1560 mm for single wing gates and 1600 x 2100 mm for double wing gates.

Each gate is delivered with a separate accessory box.

Each gate is foreseen with a product identification label, mentioning: See picture 2

- Production order number
- Sapcode
- Description gate type
- Colour
- Quantity

Page: 14 / 15 Date: 09-12-2016 Replaces version: 15-04-2016	Made up by: Werner Frans Group Quality Department	Approved by: Bart Catteeuw Product Manager	Approved by: Rafal Jordan Plant Manager	Approved by: Willy Naesens Group Quality Manager
--	--	--	---	---

The information and data given are typical for the product described. However technical changes are possible without any notice.

Technical Data Sheet  
TDS-07-95

## CreaZen® Swing Gate



**Picture 2: Position of the product identification label**

## 7 CE-marking and Declaration of Performance

### CE-marking and Declaration of Performance

These gates are provided with a **CE label**. This means Betafence guarantees the gate has been **produced** following the **CE Regulations**, as specified in the EU Construction Products Regulation (N° 305/2011).

A specific **Declaration of Performance** (DoP) is available for this type of gate with number DoP- Beta-011. The number is written on the CE label and the contents of this Declaration of Performance can be consulted and printed from the web page:

**<https://www.betafence.com/en/ce-documentation>**

Page: 15 / 15 Date: 09-12-2016 Replaces version: 15-04-2016	Made up by: Werner Frans Group Quality Department	Approved by: Bart Catteeuw Product Manager	Approved by: Rafal Jordan Plant Manager	Approved by: Willy Naesens Group Quality Manager
--	--	--	---	---

*The information and data given are typical for the product described. However technical changes are possible without any notice.*